

Procedure 7.14 - Replacing a Return Spring

Removing the Return Spring

If you are removing only one return spring, remove only one cover. It is not necessary to remove both covers unless you are removing both return springs.

1. Remove the cover necessary to access the return spring you are removing as described in Procedure 7.1.

WARNING

Before continuing with this procedure, review the Warning and Caution statements listed in Section One, Things You Should Know.

2. Press down the stair arm with one hand. With your other hand, grasp and pull the end of the stairarm belt connected to the return spring. Release the stair arm. Remove the belt from the pulley and belt idler (see Diagram 7.10).
3. Remove the return spring from the grooved belt clamp and spring bracket.
4. If you are replacing only one return spring...

THEN...

Continue with the next step.

OTHERWISE...

Repeat Steps 2 and 3 for the second spring; then continue with the next step.

Diagram 7.10 - Removing a Stairarm belt

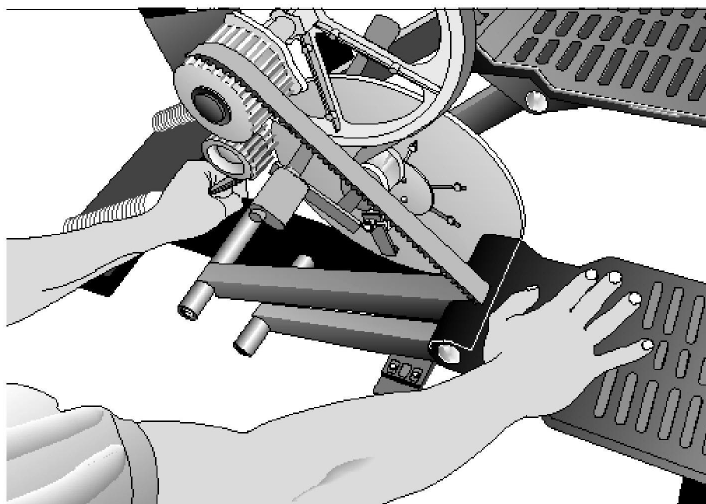

Replacing the Return Spring

5. Visually inspect the grommet for wear, cracks, or other damage. Replace the grommet if necessary.

Note:

Each spring bracket has two holes. Insert the spring into the outer hole on the bracket when you perform the next step (see Diagram 7.11).

6. Insert one end of the return spring in the spring bracket.

Note:

When you perform the next step, make sure that the end of the spring points down when you place it in the clamp.

7. Place the other end of the return spring in the grooved belt clamp. Position the spring as shown in Diagram 7.11.

Diagram 7.11 - The Return Springs

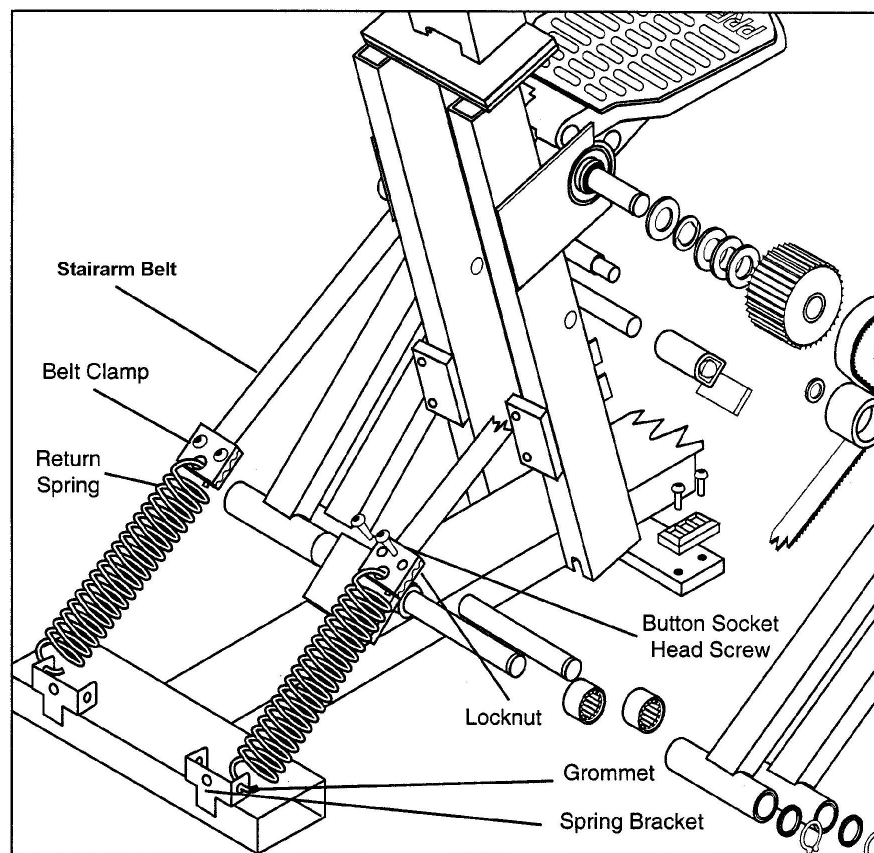

8. Lift the stair arm assembly from the frame weldment. Grasp the Stairarm belt and lift it over the toothed pulley. Route the belt under the idler pulley.
9. If you are replacing only one return spring...

THEN...

Continue with the next step.

OTHERWISE...

Repeat Steps 5 through 8 for the second spring; then continue with the next step.

10. Check the operation of the climber as described in Section Four, then replace the cover as described in Procedure 7.1.